

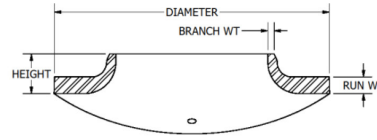

REINFORCING SADDLE



DIMENSIONS

Pipe Size		Wall Thickness			
Run NPS (DN)	Branch NPS (DN)	Height in (mm)	Diameter in (mm)	Run in (mm)	Branch in (mm)
2 – 48 (50 – 1200)	2 (50)	7/8 (22)	5 3/8 (137)	3/8 (10)	3/16 (5)
3 – 48 (80 – 1200)	3 (80)	1 (25)	7 1/2 (191)	3/8 (10)	3/16 (5)
4 – 48 (100 – 1200)	4 (100)	1 3/16 (30)	8 1/2 (216)	1/2 (13)	1/4 (6)
6 – 48 (150 – 1200)	6 (150)	1 1/4 (32)	12 (305)	1/2 (13)	1/4 (6)
8 – 48 (200 – 1200)	8 (200)	1 3/8 (35)	16 (406)	1/2 (13)	1/4 (6)
10 – 48 (250 – 1200)	10 (250)	1 1/2 (38)	20 (508)	1/2 (13)	1/4 (6)
12 – 48 (300 – 1200)	12 (300)	1 5/8 (41)	24 (610)	1/2 (13)	1/4 (6)
14 – 48 (350 – 1200)	14 (350)	1 15/16 (49)	28 (711)	1/2 (13)	1/4 (6)
16 – 48 (400 – 1200)	16 (400)	2 3/16 (56)	32 (813)	1/2 (13)	1/4 (6)
20 – 48 (500 – 1200)	20 (500)	2 1/2 (64)	40 (1016)	1/2 (13)	1/4 (6)
24 – 48 (600 – 1200)	24 (600)	2 11/16 (68)	48 (1219)	1/2 (13)	1/4 (6)

Key Features:

- Designed to provide reinforcement to a branch connection
- Saddle provided with a vent hole to prevent entrapment of gasses during welding
- Not designed to contain internal pressure
- Satisfy the requirements of ASME B31.3, B31.4, B31.8 and other applicable design codes
- Standard saddles manufactured to A234 grade WPB, MSS-SP75 WPHY-52, 60, 65 & 70
- Stainless and low alloy saddles available to match customer requirements
- Manufactured in compliance with WeldFit's ISO 9001:2008 certified quality program

Ordering Information:

- Run pipe size
- Outlet pipe size
- Material required

Dimensions Subject to Change Without Notice

Confidential and Proprietary Information



4133 Southerland _ Houston, Texas 77092

p: 713.460.3700 _ f: 713.939.1808

www.weldfit.com